

FOUNDATIONS  
STANDARD FOUNDATIONS AS SHOWN.  
4x1.5x1.5 DEEP AND 4.5x1.5x1.5mDEEP  
OR ACCORDING TO GROUND CONDITIONS

NOTES:  
ALL DIMENSIONS ARE IN mm  
ALL ST. STEEL MUST BE HOT DIPPED  
GALVANISED AFTER FABRICATION

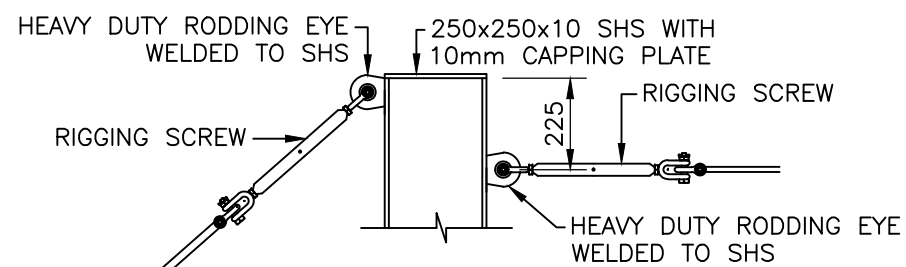
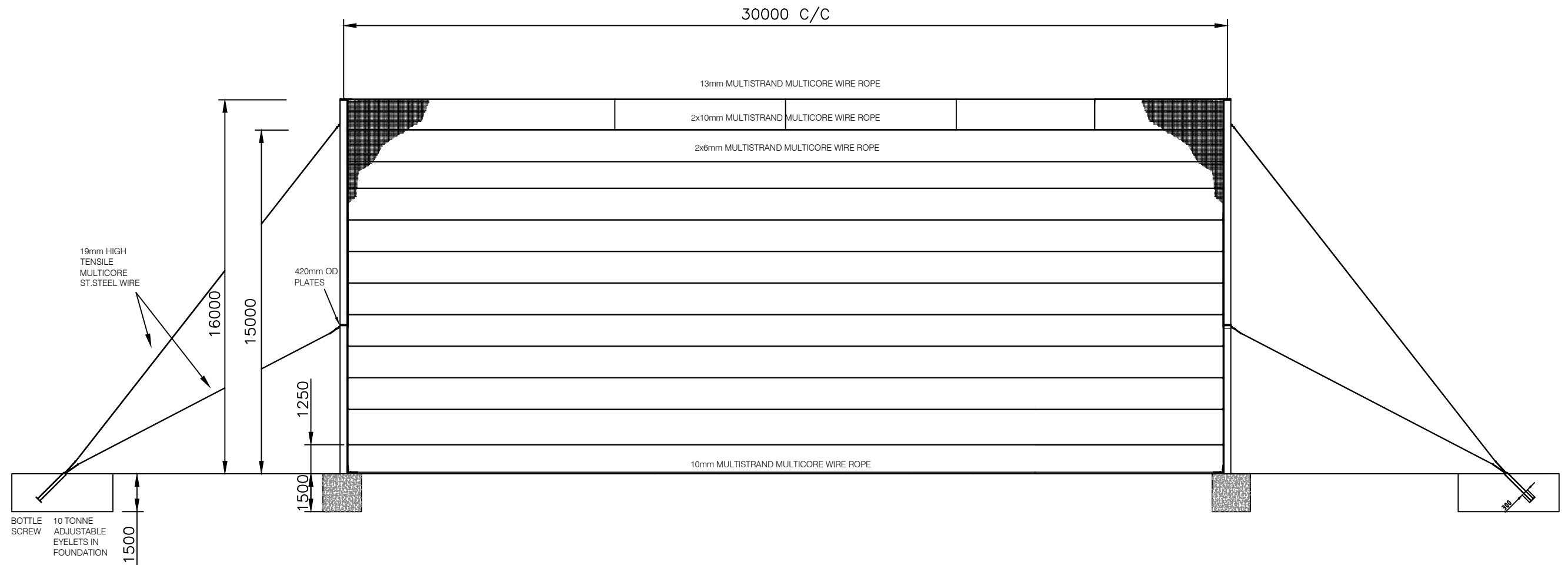

DETAIL A  
SCALE 1:20

REV:	DATE:	DESCRIPTION:
PATH: Z:\INFO\SALES CAD 2016\A.Mesh Perimeter Range		
<b>Irish Fencing Services</b> SECURE ENHANCE PROTECT Dublin - Cork - Newry Irish Fencing & Services Unit 21, Jamestown Business Park, Kylemore Way, Dublin 8 Tel: +353(0) 1 6268363   Fax: +353(0) 1 6262309 www.irishfencing.com		
STANDARD SALES DRAWING 2016		
TITLE		IRFEN®
16m HIGH BALLSTOP SYSTEM		
SCALE	N.T.S	DATE 19/07/16
DRAWN TOB	CHECKED SW	APPROVED SW
DRG No. B-0803		REV.